

Collection Napoli



Verwöhnen Sie Ihre Gäste mit zeitgemäßem Service.
Und zeitloser Schönheit.

Viziate i vostri ospiti con un'assistenza che riesca a soddisfare
tutte le loro necessità. E con una bellezza intramontabile.

Pamper your guests with up-to date service. And timeless beauty.

Der Name Napoli ist nicht zufällig gewählt – schließlich haben diese Möbel einen ganz typischen italienischen Charme. Napoli ist genau der Rahmen, in dem Ihre Gäste den Aufenthalt genießen. Denn dieses Interieur besticht durch seine verführerische Schönheit.

Il nome Napoli non è una scelta casuale: questi mobili in verità hanno un fascino tipicamente italiano. Napoli è proprio quella cornice nella quale i vostri ospiti si troveranno perfettamente a loro agio. Questi interni seducono con la loro irresistibile bellezza.

The name Napoli was not chosen by chance, since these pieces of furniture are possessed with a very typical Italian charm. Napoli is absolutely the setting in which your guests can best enjoy their stay. Because this interior fascinates with its alluring beauty.





H0211 Kopfteil Doppelbett / Testata letto matrimoniale /
Double bed headboard cm 188x797 in 74x2.8/38.2
H0512 Kommödchen / Comodino / Night stand
cm 60x40/65 in 23.6x15.7/25.6

- H0211** Kopfteil Doppelbett / Testata letto matrimoniale / Double bed headboard
cm 188x7/97 in 74x2.8/38.2
- H0512** Kommödchen / Comodino / Night stand
cm 60x40/65 in 23.6x15.7/25.6
- H1312** Sessel / Poltrona / Armchair
cm 67x65/98/44 in 26.4x25.6/38.6/17.3
- 1445** Hocker / Sgabello / Ottoman
cm 70x40/41 in 27.6x15.7/16.1
- H0310** Bistrotisch / Tavolino bistrò / Bistro table
cm Ø 70/70 in Ø 27.6/27.6



H0710 Schrank / Armadio / Wardrobe
cm 114x62(53)/200 in 44.9x24.4(20.9)/78.7



H1230 Kopfteil Doppelbett gepolstert /
Testata letto matrimoniale imbottita /
Double bed headboard, upholstered
cm 180x16/140 in 70.9x6.3/55.1



H0610 Schreibtisch / Scrivania / Desk
cm 130x60/77 in 51.2x23.6/30.3
H1310 Stuhl / Sedia / Chair
cm 47x49/98/50 in 18.5x19.3/38.6/19.7



H0211 Kopfteil Doppelbett / Testata letto matrimoniale /
Double bed headboard cm 188x7/97 in 74x2.8/38.2
H0512 Kommödien / Comodino / Night stand
cm 60x40/65 in 23.6x15.7/25.6

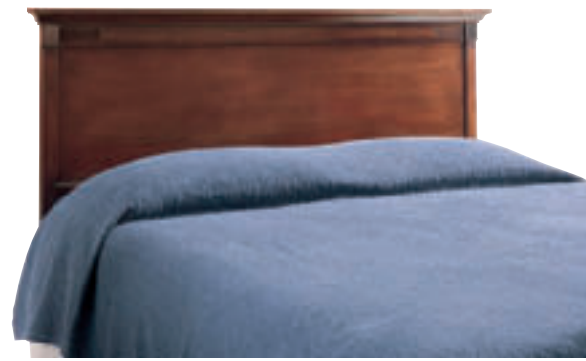

H0211 cm 188x7/97 in 74x2.8/38.2
Kopfteil Doppelbett / Testata letto matrimoniale / Double bed headboard



H1230 cm 180x16/140 in 70.9x6.3/55.1
H1231 cm 200x16/140 in 78.7x6.3/55.1
Kopfteil Doppelbett gepolstert / Testata letto matrimoniale imbottita / Double bed headboard, upholstered



3112 cm 70x70/50 in 27.6x27.6/19.7
Salontisch / Tavolino da salotto / Coffee table

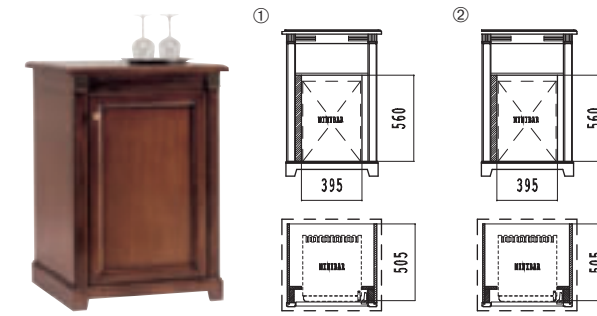

H0510 cm 65x60/96 in 25.6x23.6/37.8
Minibar Möbel RX / Mobile minibar DX / Minibar unit RX

① Innenmaß mit Passleiste / Misura vano con fascia di tamponamento / Measurements with buffer strip
② Innenmaß ohne Passleiste / Misura vano senza fascia di tamponamento / Measurements without buffer strip



H0512 cm 60x40/65 in 23.6x15.7/25.6
Kommödden / Comodino / Night stand



H0511 cm 120x45/93 in 47.2x17.7/36.6
Kommode / Comò / Chest of drawers



H0310 cm Ø 70/70 in Ø 27.6/27.6
Bistrotisch / Tavolino bistrò / Bistro table



H0610 cm 130x60/77 in 51.2x23.6/30.3
Schreibtisch / Scrivania / Desk



H0611 cm 142x55/77 in 55.9x21.7/30.3
Schreibtisch/Minibar LX / Scrivania minibar SX / Desk/minibar unit, left

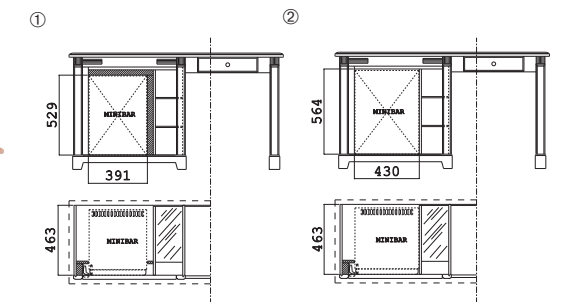

① Innenmaß mit Passleiste / Misura vano con fascia di tamponamento / Measurements with buffer strip
② Innenmaß ohne Passleiste / Misura vano senza fascia di tamponamento / Measurements without buffer strip



H1073 cm 65x41/50 in 25.6x16.1/19.7
Kofferablage / Portavaligie / Luggage stand



H1226 cm 120x40/45 in 47.2x15.7/17.7
Kofferablage / Portavaligie / Luggage stand



H1274 cm 120x40/60 in 47.2x15.7/23.6
Kofferablage / Portavaligie / Luggage stand



H0710 cm 114x62(53)/200 in 44.9x24.4(20.9)/78.7
Schrank / Armadio / Wardrobe



H0711 cm 160x62(53)/200 in 63x24.4(20.9)/78.7
Schrank / Armadio / Wardrobe



H4176 cm 90x55/67/50 in 35.4x21.7/26.4/19.7
Kofferablage / Portavaligie / Luggage stand



H9800 cm 61x49/68 in 24x19.3/26.8
Kofferablage / Portavaligie / Luggage stand



H0910 cm 70x7/170 in 27.6x2.8/66.9
Garderobenspiegel / Pannello con specchio /
Coat rack/mirror



H0912 cm 70x10/170 in 27.6x3.9/66.9
Garderobenelement / Pannello appendiabiti /
Coat rack



H1312 cm 67x65/98/44 in 26.4x25.6/38.6/17.3
Sessel / Poltrona / Armchair



H1310 cm 47x49/98/50 in 18.5x19.3/38.6/19.7
Stuhl / Sedia / Chair



1224 cm 68x78/102/45 in 26.8x30.7/40.2/17.7
Sessel / Poltrona / Armchair



1264 cm 47x60/104/48 in 18.5x23.6/40.9/18.9
Stuhl / Sedia / Chair



1470 cm 48x58/94/48 in 18.9x22.8/37/18.9
Stuhl / Sedia / Chair



1471 cm 56x60/94/48 in 22x23.6/37/18.9
Armlehnstuhl / Sedia con braccioli / Armchair



1700 cm 48x58/94/48 in 18.9x22.8/37/18.9
Stuhl / Sedia / Chair



1701 cm 56x60/94/48 in 22x23.6/37/18.9
Armlehnstuhl / Sedia con braccioli / Armchair

Hölzer und Oberflächen

Legni e Finiture

Woods and Finishes

Holz

Massivteile: Linde
Furnierte Teile: Kirsch

Legno

Parti massicce: Tiglio
Parti impiallacciate: Ciliegio

Wood

Solid sections: Linden
Veneered sections: Cherry

Zierbeschläge

Für die Collection Napoli verwenden wir einen muschelförmigen Zierbeschlag in Messing, antikisiert und brüniert. Als Alternative dazu, legen wir dem Möbel auch einen Griffknopf mit rhombenförmiger Dekorplakette bei.

Ferramenta ornamentale

Abbiamo impreziosito la collezione Napoli con una maniglia a forma di conchiglia in ottone brunito ed anticato. In alternativa includiamo pomoli con placchetta decorativa a forma di rombo.

Fittings

For the Collection Napoli, we use shell-shaped decorative fittings in brass that have been antiqued and burnished. As an alternative to that, we also include a handle knob with a rhombus-shaped decorative plaque.

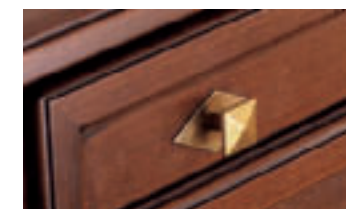

Oberflächen / Finiture / Finishes



s = Nussbaumfarbig antik dunkel; DD-Lack / Finitura tinta noce anticato scuro, finito con lacca a due componenti / Antique dark walnut-coloured; two-component lacquer



k = Kirschbaumfarbig; DD-Lack / Finitura tinta ciliegio, finito con lacca a due componenti / Cherry-coloured with two-component lacquer

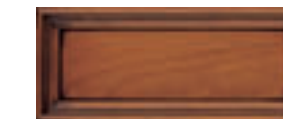

zz = Kirschbaumfarbig antik; DD-Lack / Finitura tinta ciliegio anticato, finito con lacca a due componenti / Antique cherry-coloured; two-component lacquer

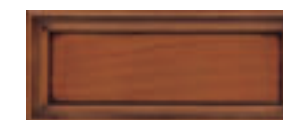

mm = Französisch kirschbaumfarbig; DD-Lack / Finitura tinta ciliegio francese, finito con lacca a due componenti / French cherry-coloured; two-component lacquer



L = Elfenbeinfarbig antikisiert; Acryllack / Finitura avorio anticato con lacca acrilica / Ivory-coloured, antiqued with acrylic lacquer

SELVA

SELVA HOSPITALITY - A DIVISION OF SELVA AG/SPA

Selva AG-SpA | via Luigi Negrelli Straße 4 | 39100 Bozen-Bolzano Italy
www.selva.com | selva@selva.com

Edition 1:01/08